

# Essex Silverline SL7 Edger

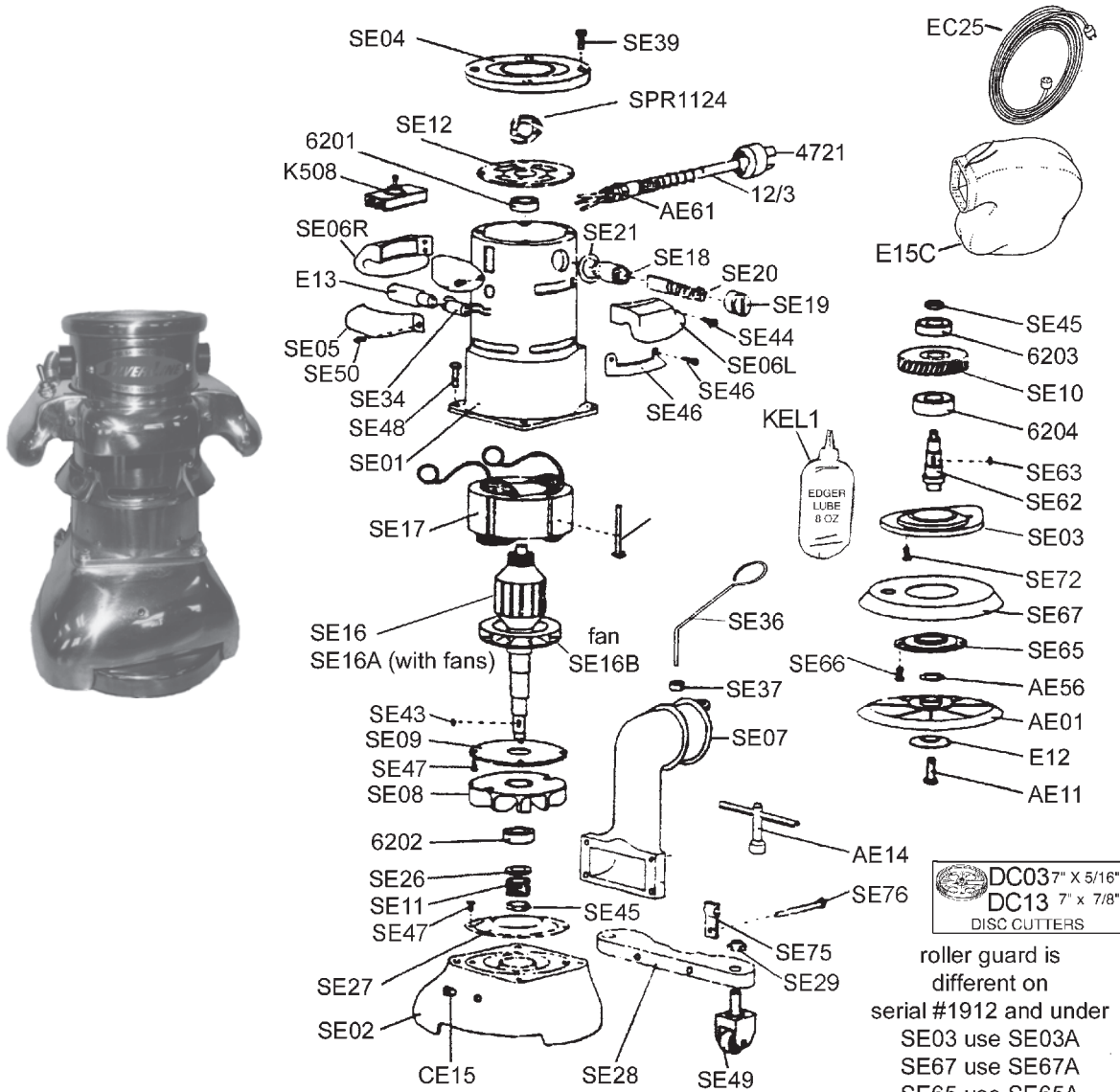

roller guard is different on serial #1912 and under  
 SE03 use SE03A  
 SE67 use SE67A  
 SE65 use SE65A

Part #	Description
4721	#N/A
6201	Bearing
6202	Bearing
6203	Bearing
6204	Bearing
12/3	Gray Cable
AE01	Edger Pad
AE11	Paper Screw
AE14	Edger wrench
AE56	Felt Washer
AE61	Cord Relief
CE15	Grease Plug
DC03	7 x 7/8" Cutter
DC13	7 x 5/16 Cutter
E12	Paper Washer
E13	115V Bulb
E15C	Red Edger Bag
EC25	25' 12/3 110v Cord
K508	LD Edger Sw
KEL1	Edger Lube
SE01	Motor Frame
SE02	Gear housing

Part #	Description
SE03A	Gear Cover Old
SE05	Lamp shield
SE06L	LH Handle
SE06R	RH Handle
SE07	Dust Pipe
SE08	VAC FAN
SE09	Baffle
SE10	Large Gear
SE11	Small Gear
SE12	Bear plate
SE16	Armature
SE16A	Armature Complete
SE16B	Complete ARM
SE17	Field SL7
SE18	Brush Holder
SE19	Brush Cap New
SE20	SL-7 Brush SET 2
SE21	Insulator
SE26	Spacer
SE27	Venturi Plate
SE28	Wheel bracket
SE29	Nut Lock

Part #	Description
SE34	Lamp Socket
SE36	Support
SE37	Collar
SE39	Screw
SE43	Key
SE44	Screw
SE45	Nut LH
SE46	Shield
SE47	Screw
SE48	Screw Hous
SE49	Caster
SE50	Screw
SE62	Jackshaft
SE63	Key
SE65A	Guard OLD
SE66	Screw disc
SE67A	Guard OLD
SE72	Screw
SE75	Wrench clip
SE76	Screw
SPR1124	Load Spring