

HUMMEL 8

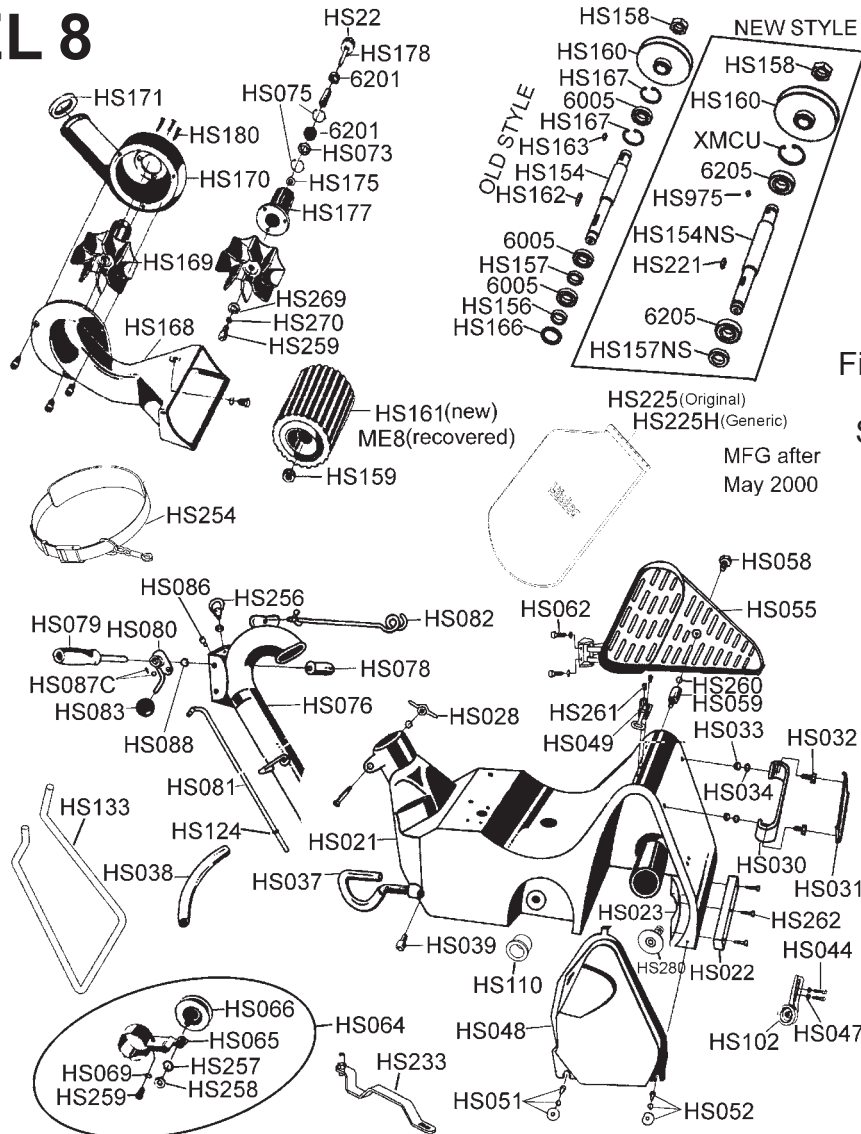

Belt Drum Puller
Fits all Drums 8", 10", 12"

SW09



MFG after
May 2000

28

Part #	Description
6005	Bearing
6201	Bearing
6205	Bearing
HS021	Housing
HS022	Bumper, Felt
HS023	Sealing, Felt
HS028	Wing Nut
HS030	Bracket
HS031	Grip
HS032	Hex Head Screw
HS033	Nut
HS034	Washer
HS037	Safety Guard
HS038	PVC Tube
HS039	Socket Screw
HS044	Screw
HS047	Washer
HS048	Cover
HS049	Cover Fastener
HS051	Collar Nut
HS052	Collar Nut
HS055	Compl Belt Guard
HS058	Knurled Screw
HS059	Screw Stud
HS062	Hew Head Screw
HS064	Belt Tensioner
HS065	Belt Tension Arm
HS066	Belt Ten Pulley

Part #	Description
HS069	Nut
HS073	Nilos Ring
HS075	Circlip
HS076	Guide Tube
HS078	Short Handle
HS079	Long Handle
HS080	Lever
HS081	Upper Rod
HS082	Compleat Support
HS083	Ball Knob
HS086	Grub Screw
HS087C	Cap Kit
HS088	Circlip
HS102	Roller Assembly
HS110	Roller Asm. OEM
HS124	#N/A
HS133	Lifting Fixture
HS154	Sanding Shaft
HS154NS	Drum Shaft NS
HS156	Slide Ring
HS157	Spacer Ring
HS157NS	spacer
HS158	RH Hex Nut
HS159	LH Hex Nut
HS160	V-Belt Pulley
HS161	New Drum
HS162	Key
HS163	Key

Part #	Description
HS166	Oil Seal
HS167	Circlip
HS168	Intake Duct
HS169	Fan Complete
HS170	Fan Housing
HS171	Sealing Ring
HS175	Spacer Brush
HS177	Bearing Housing
HS178	Fan Shaft new
HS180	Screw
HS22	Fan Pulley
HS221	Key
HS225	Dust Bag
HS225H	Bag, Generic Red
HS233	Setting Fixture
HS254	Safety Belt
HS256	Eye Bolt
HS257	Washer
HS259	Socket Screw
HS260	O Ring
HS261	Pan Head Screw
HS262	Screw
HS269	Washer
HS270	Washer
HS280	Guide Roller
HS975	Key
ME8	Recovered Drum
XMCU	housing ring

HUMMEL 8

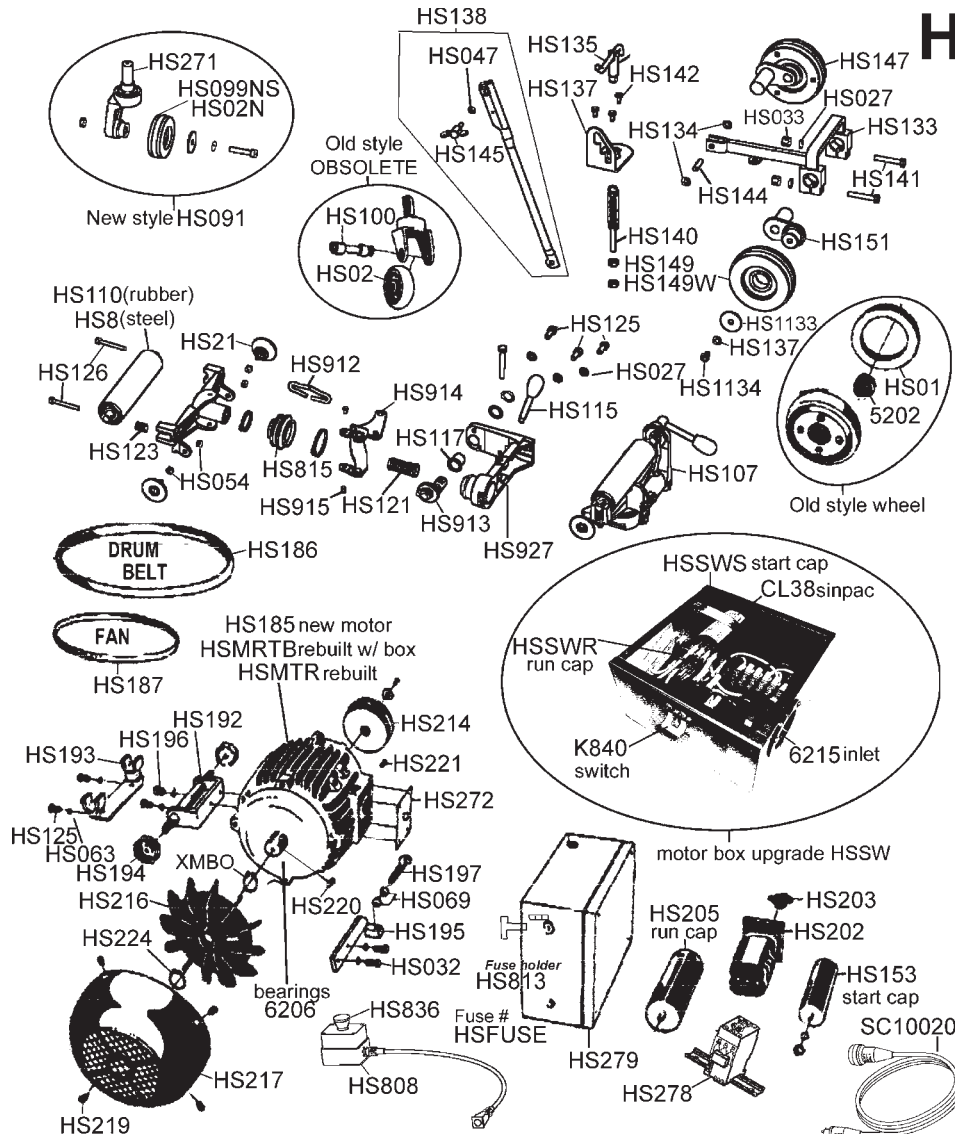

Part #	Description
5202	Bearing
6206	Bearing
6215	Inlet
CL38	Start Switch
HS01	Side Wheel
HS02	Rear Wheel
HS027	Washer
HS02N	Wheel NS US
HS032	Hex Head Screw
HS033	Nut
HS047	Washer
HS054	Washer
HS063	Spring Washer
HS069	Nut
HS091	Rear Whl Comp
HS099NS	Wheel NS OEM
HS100	Complete Axle
HS107	Top Roller Comp
HS110	Roller Asm. OEM
HS1133	Washer
HS1134	Screw
HS115	Operating Lever
HS117	Bearing Bush
HS121	Comp Spring
HS123	Compr Spring
HS1258	#N/A
HS126	Socket Screw
HS133	Lifting Fixture

Part #	Description
HS134	Pivot Screw
HS135	Spring Tensioner
HS137	Notch Plate
HS138	Lower Rod
HS140	Tension Spring
HS141	Hew Head Screw
HS142	Screw
HS144	Split Pin
HS145	Wing Screw
HS147	Compl Wheel
HS149	Wheel NS OEM
HS149W	Wheel NS US
HS151	Wheel Arm
HS153	Start Capacitor
HS185	New Motor
HS186	Drum Belt
HS187	V Belt
HS192	Motor Mounting
HS193	Bearing Bracket
HS194	Motor Nut
HS195	Motor Tensioner
HS196	Hex Head Screw
HS197	Eye Bolt
HS202	Switch
HS203	Switch Knob
HS205	Run Capacitor
HS21	Edge Guide
HS214	Motor Pulley

Part #	Description
HS216	Fan Wheel
HS217	Fan Cover
HS219	Screw
HS220	Key
HS221	Key
HS224	Circlip
HS271	Yoke Housing
HS272	Sealing Plate
HS278	Contactora
HS279	Switch Box
HS8	8" Roller Assm
HS808	Switch Emerg. Asm
HS813	Fuse Holder
HS815	Collar Rubber NS
HS912	Clip
HS913	top roller cam
HS914	Actuator NS
HS915	Screw
HS927	Base, Asm
HSFUSE	Fuse
HSMRTB	MTR & BOX
HSMTR	Reblt Mtr NoCon
HSSW	Switch Box Mod
HSSWR	Cap Run
HSSWS	Cap Start
K840	CKT BRK. 30amp
SC10020	10/3 100ft, 20amp
XMBO	clip ring