

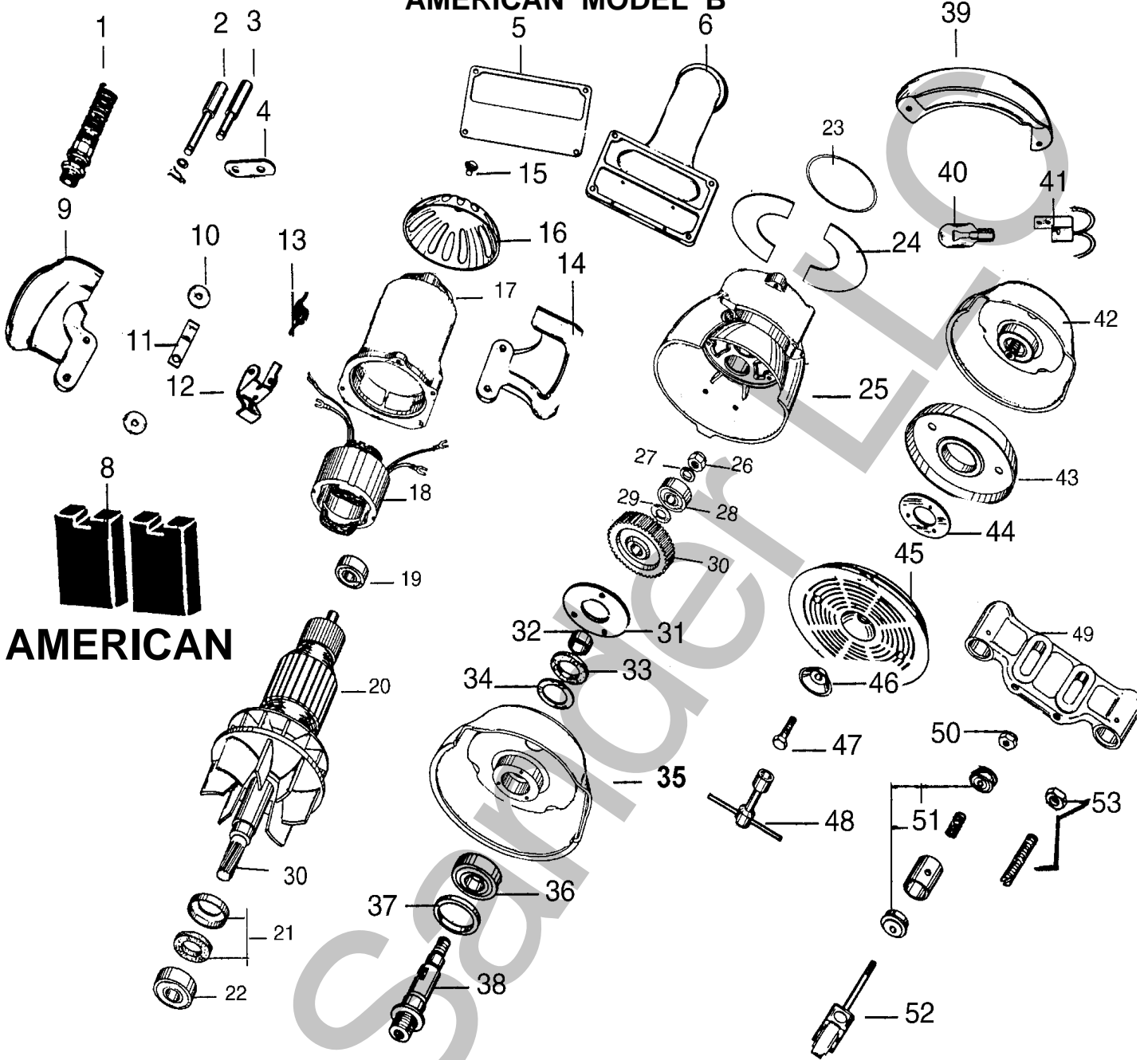



# AMERICAN MODEL B



**AMERICAN**

5" AW Edger	7" AW Edger
 <p>54</p> <p>Motor Brushes AE51</p>	 <p>56</p> <p>Motor Brushes AE10</p>
<p>Brush Cap AE52</p>  <p>55</p>	<p>Brush Cap AE04</p>  <p>57</p>

ILL. #	PART #	Description
1	AE61	Cord Relief
2	AE57	Long Swivel
3	AE58	Short Swivel
4	AE42	Insulator
5	*****	
6	*****	
7	*****	
8	AE08	Brushes Set 2
9	*****	
10	AE22	Gasket
11	AE03	Wrench Clip
12	AE28	Brush Holder
13	AE27	Brush Spring
14	*****	
15	AE30	Cover Screw
16	*****	
17	*****	
18	*****	
19	6201	Bearing
20	*****	
21	AE18	Armature Seal
22	6203	Bearing
23	*****	
24	*****	
25	*****	
26	*****	
27	*****	
28	6201	Bearing
29	*****	

ILL. #	PART #	Description
30	AE120	Gear Set BE
31	*****	
32	*****	
33	AE17	Jack Shaft Seal
34	*****	
35	*****	
36	6202	Bearing
37	*****	
38	AE121	JackShaft
39	*****	
40	E13	115V Bulb
41	AE23	Light Socket
42	*****	
43	*****	
44	*****	
45	AE01	Edger Pad
46	E12	Paper Washer
47	AE11	Paper Screw
48	AE14	Edger wrench
49	AE07	Caster Bracket
50	AE36	Stop Nut
51	AE06	Caster Bearing
52	AE05	Caster
53	AE38	Nut & Screw
54	AE51	Brushes
55	AE52	Brush Cap
56	AE10	Brushes 2 Per Se
57	AE04	Brush Cap

**FELT OR MAROON BACKING PADS ARE AVAILABLE**



**SEE PAGE 117**

Note: Prices may vary from actual cost due to computer rounding or typographical errors. Prices may vary at any time.